



SC7236D Series



1. Features:

- Alloy powder based SMD Inductor with lower core loss.
- Custom values are welcomed.
- High current output chokes, up to 26.0 Amp with approx. 30% roll off.
- Flat wire windings provide extremely low DC and AC resistance.
- Operating Temperature Range -55°C to +130°C, RoHs & HF compliance.
- T & R Qty: 150 pcs , 13" Reel.

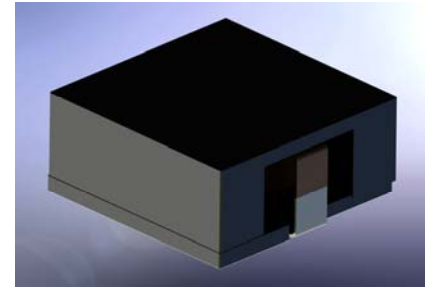

2. Mechanical Dimension (Unit in mm):

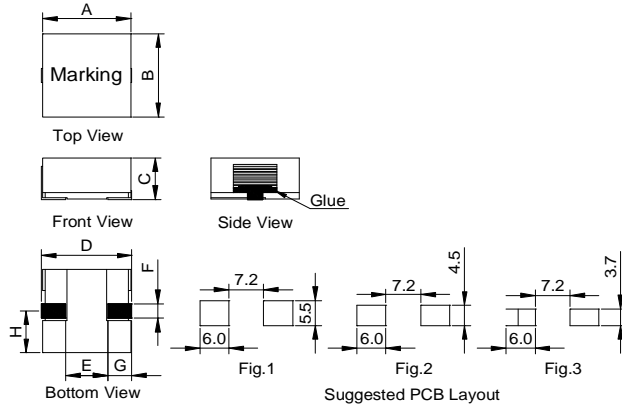

Type	SC7236D
A	18.2 ± 0.5
B	18.2 ± 0.5
C	9.5 (Max.)
D	18.2 ± 1.0
E	8.2 (Ref.)
F	See Table
G	5.0 ± 1.0
H	9.1 ± 1.0

3. Electrical Characteristics:

EMC Part Number	OCL (uH) ±20%	DCR (mΩ) ±8%	Isat (A) @25°C	Irms (A) @25°C	Dim. F (mm) ± 0.5	PCB Layout Fig.
SC7236D-7R6MHF	7.6	3.9	26.0	23.0	4.2	1
SC7236D-9R5MHF	9.5	4.8	22.0	21.0	4.2	1
SC7236D-110MHF	11.0	5.9	21.0	18.5	4.2	1
SC7236D-140MHF	14.0	6.9	20.0	17.5	4.2	1
SC7236D-160MHF	16.0	8.7	17.5	15.5	4.2	1
SC7236D-190MHF	19.0	9.0	16.0	15.0	4.2	1
SC7236D-220MHF	22.0	10.7	15.3	14.0	4.2	1
SC7236D-250MHF	25.0	13.8	14.5	12.0	4.2	1
SC7236D-280MHF	28.0	14.6	14.0	11.5	4.2	1
SC7236D-320MHF	32.0	19.3	13.0	10.5	3.2	2
SC7236D-360MHF	36.0	20.4	12.5	10.0	3.2	2
SC7236D-400MHF	40.0	21.5	12.0	9.5	3.2	2
SC7236D-440MHF	44.0	21.7	11.7	9.2	3.2	2
SC7236D-480MHF	48.0	32.8	10.5	8.0	2.4	3
SC7236D-530MHF	53.0	33.5	9.8	7.7	2.4	3
SC7236D-580MHF	58.0	43.0	9.5	6.7	2.4	3
SC7236D-630MHF	63.0	44.1	9.0	6.5	2.4	3
SC7236D-680MHF	68.0	45.0	8.8	6.4	2.4	3
SC7236D-730MHF	73.0	47.0	8.7	6.3	2.4	3
SC7236D-790MHF	79.0	48.5	8.6	6.2	2.4	3
SC7236D-850MHF	85.0	50.0	7.8	6.0	2.4	3

Note:

1. Open Circuit Inductance(OCL) and L@Irms and L@Isat are measured at: 300KHz, 0.25V (Ta=25°C).
2. Isat: DC current that causes inductance to drop 30%(Typ.) from OCL ;(Ta=25°C).
3. Irms: DC current that causes an approximate temperature rise (ΔT) of 40°C;(Ta=25°C).
4. Inductance vs. DC Current curve, please see the next page to get more detail information.

● Taiwan 886 2 2698 9699 ● Dongguan 86 769 8791 5567 ● Suzhou 86 512 6832 1472

Sales@easymagnet.com.tw www.easymagnet.com.tw Rev. A, Apr. 18, 2015



SC7236D Series

Inductance vs. Current Characteristics

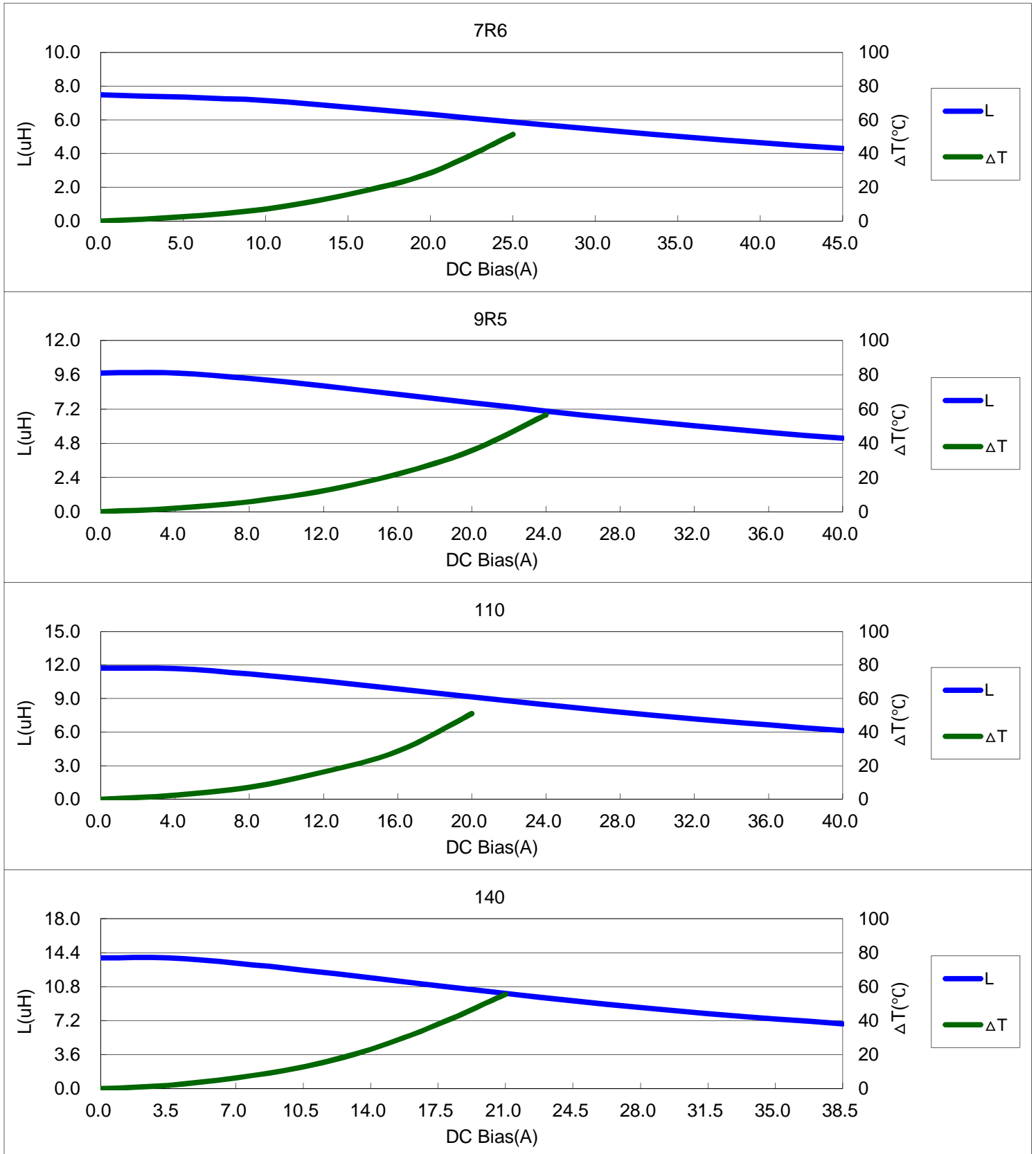



SC7236D Series

Inductance vs. Current Characteristics

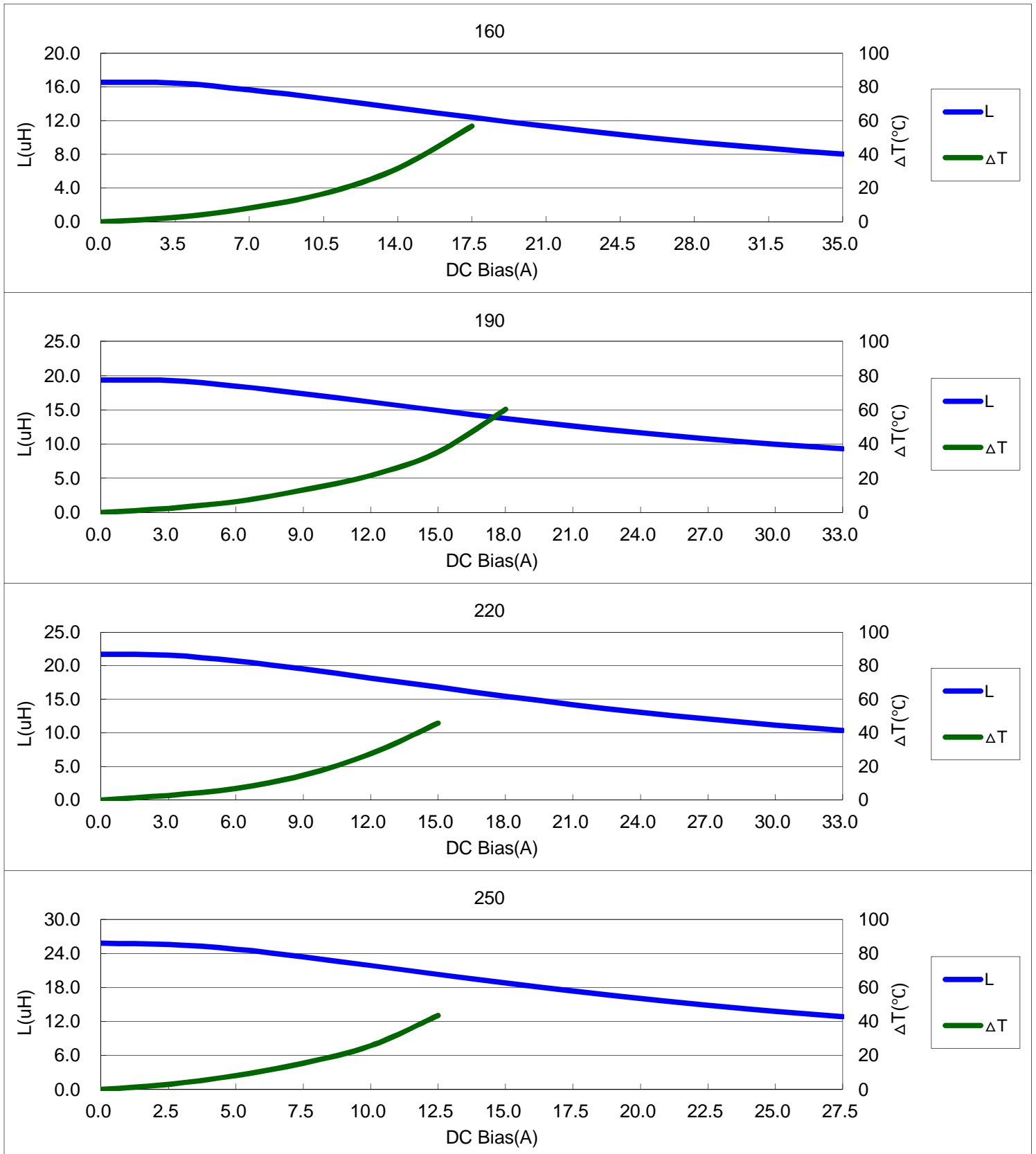



SC7236D Series

Inductance vs. Current Characteristics

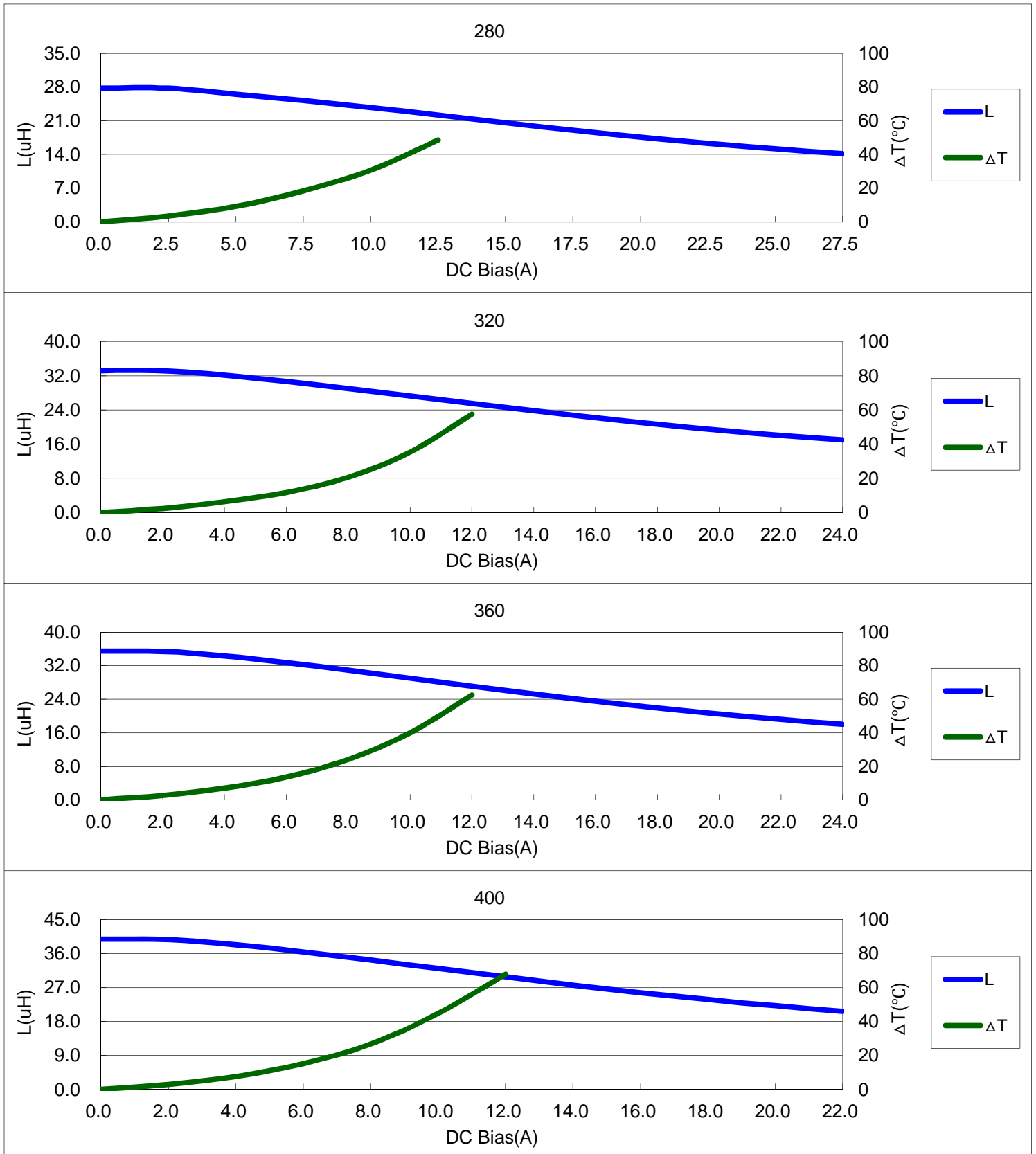



SC7236D Series

Inductance vs. Current Characteristics

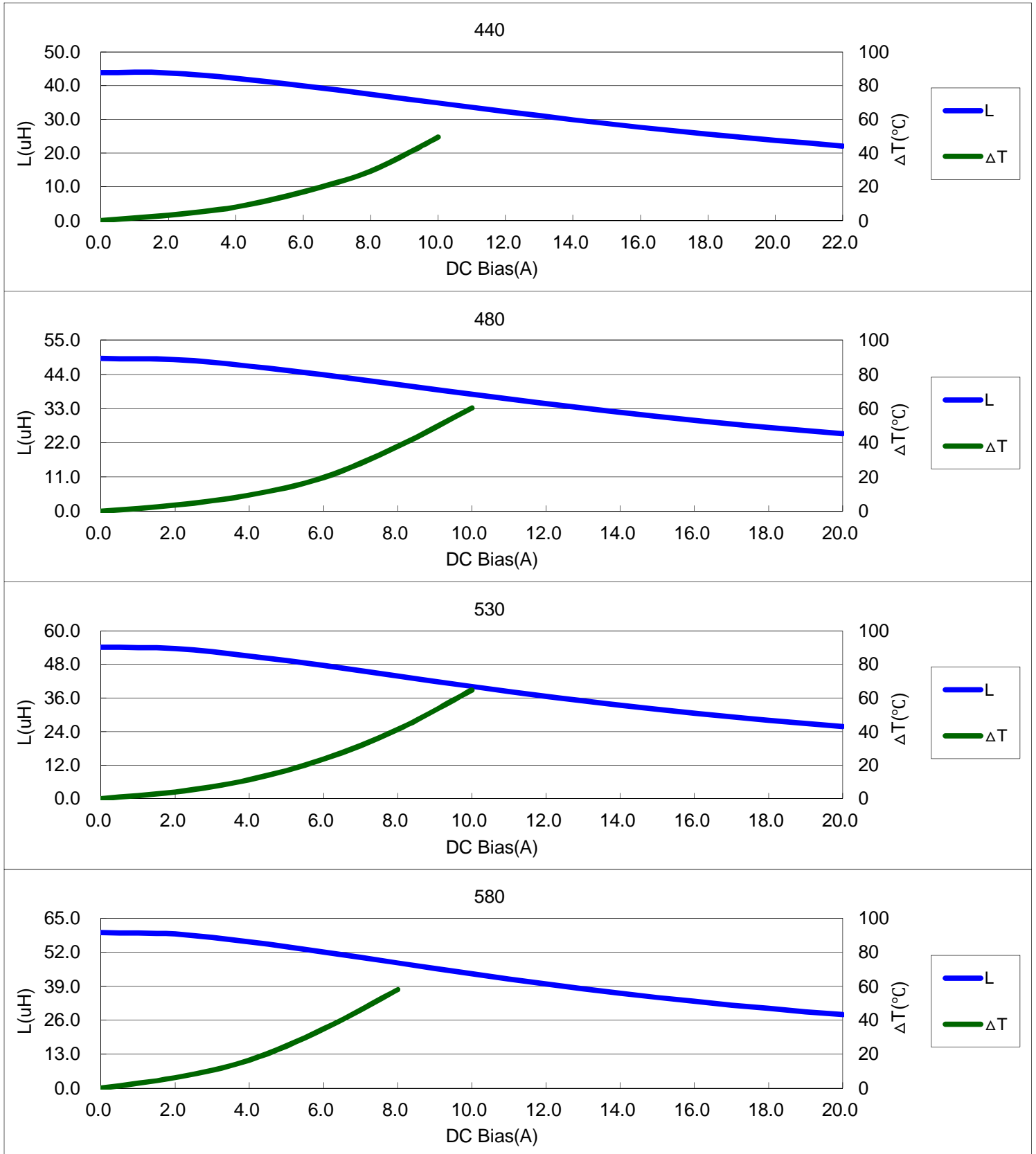



SC7236D Series

Inductance vs. Current Characteristics

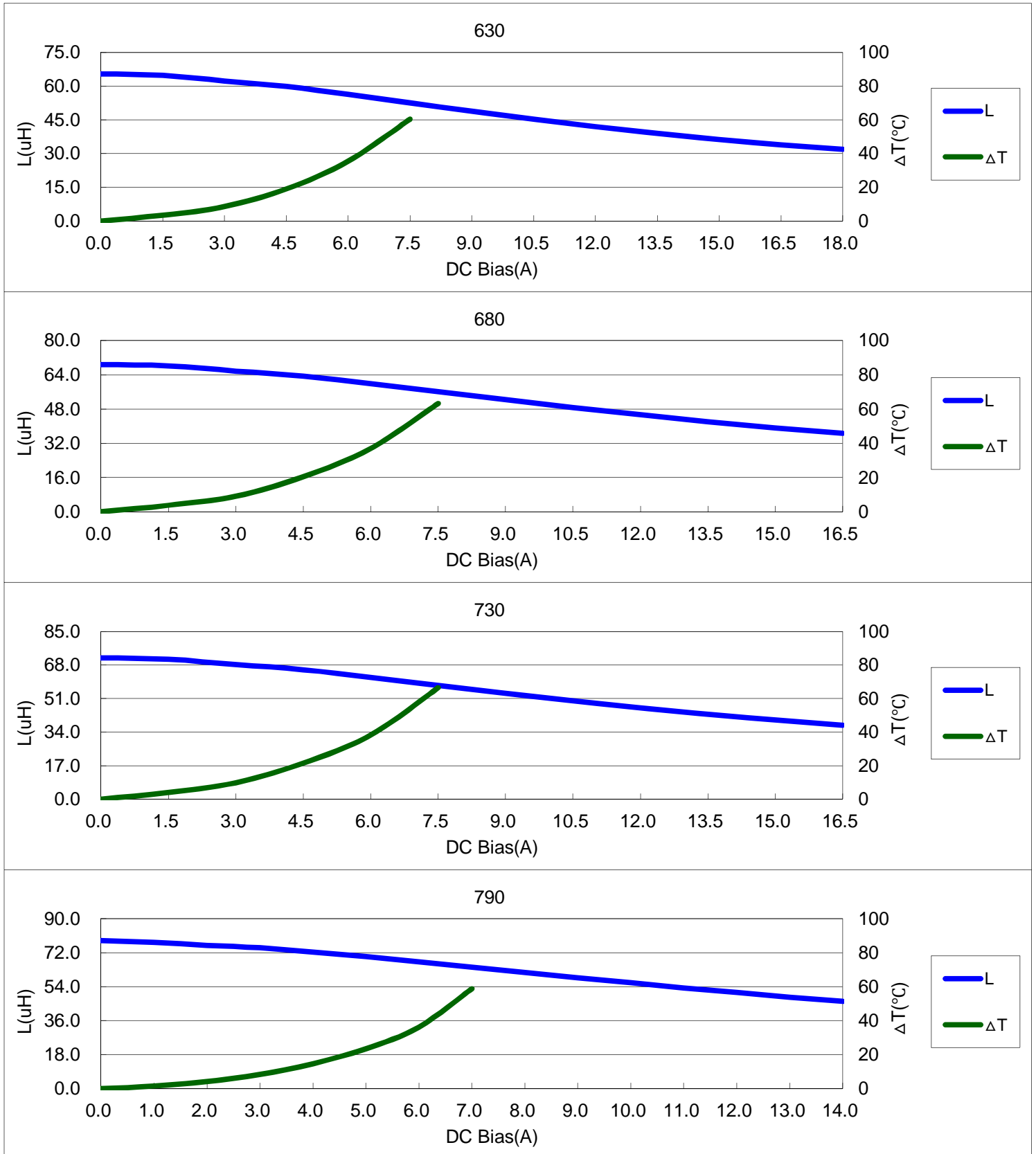



SC7236D Series

Inductance vs. Current Characteristics

