



VOLTAGE MULTIPLIERS INC.
8711 W. Roosevelt Ave.
Visalia, CA 93291

PROPRIETARY AND CONFIDENTIAL
THE INFORMATION CONTAINED IN THIS DRAWING IS THE SOLE PROPERTY OF
VOLTAGE MULTIPLIERS INC. ANY REPRODUCTION IN PART OR AS A WHOLE WITHOUT
THE WRITTEN PERMISSION OF VOLTAGE MULTIPLIERS INC. IS PROHIBITED.

ORIGINAL RELEASE

DRN BY: *[Signature]*
Design Engineering: *[Signature]*
DATE: 10-19-17
Process Engineering: *[Signature]*
DATE: 10-19-17
DO NOT SCALE DRAWING SCALE: 2:1

UNLESS OTHERWISE SPECIFIED:
DIMENSIONS ARE IN INCHES
TOLERANCES:
XXX ±.005

DWG. NO.

SMF150

REV:

-

SHEET: 1

REVISION STATUS OF SHEETS

SHT	1	2					
REV	-	-					

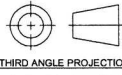

THIRD ANGLE PROJECTION

ECO:

TITLE:

Molded Rectifier

ELECTRICAL CHARACTERISTICS AND MAXIMUM RATINGS

Part Number	Working Reverse Voltage (V _{rw})	Average Rectified Current (I _o)		Reverse Current @ V _{rw} (I _r)		Forward Voltage (V _f)		1 Cycle Surge Current tp=8.3ms (I _{fsm})	Repetitive Surge Current (I _{frm})	Reverse Recovery Time (3) (T _{rr})	Thermal Impd. θ (J-L)	Junction Cap. @ 50VDC @ 1kHz (C _j)
		55°C(1)	100°C(2)	25°C	100°C	25°C		25°C	25°C	25°C	25°C	25°C
		Volts	mA	mA	µA	µA	Volts	mA	Amps	Amps	ns	°C/W
SMF150	15000	10	5	0.1	10	35.0	10	1.0	0.20	100	40	0.5

(1) TC=55°C (2) TC=100°C (3) If=12.5mA Ir=25.0mA Irr=6.3mA * Op. Temp.= -65°C to +175°C Stg. Temp.= -65°C to +200°C

DISTRIBUTED
10-19-17

PHYSICAL CHARACTERISTICS

MARKINGS:

- B VMI
- A SMF150
- N
- D

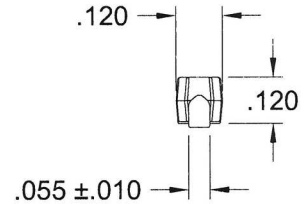
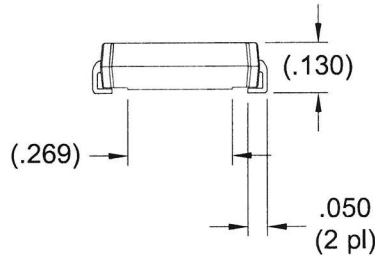
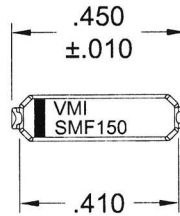
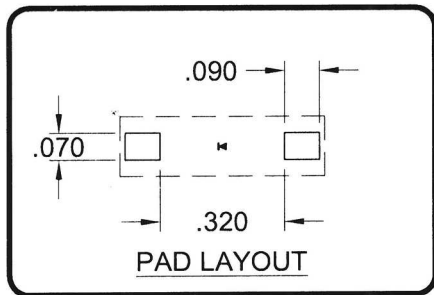

Dimensions: In. (mm) * All temperatures are ambient unless otherwise noted. * Data subject to change without notice.